

OFFICE AND RETAIL SPACE

909 E ST PATRICK STREET
RAPID CITY, SD 57701

FOR LEASE



PROPERTY HIGHLIGHTS

- ▶ **Suite 1**—12,176 SF—End cap retail, great signage. Open floor plan with private office/delivery on the south end of the unit.
- ▶ **Suite 7**—4,895 SF—Medical office. Large common area with restrooms and waiting area, 3 exam rooms, perimeter offices. Building exit at the back of building for employees.

PROPERTY OVERVIEW

Great location! Frontage on high-traffic E St Patrick Street, 12,402 vehicles per day. Lots of parking and easy access from E St Patrick and E St Francis via Meade St. Foot traffic from neighboring salons and Happy Jack's Casino.

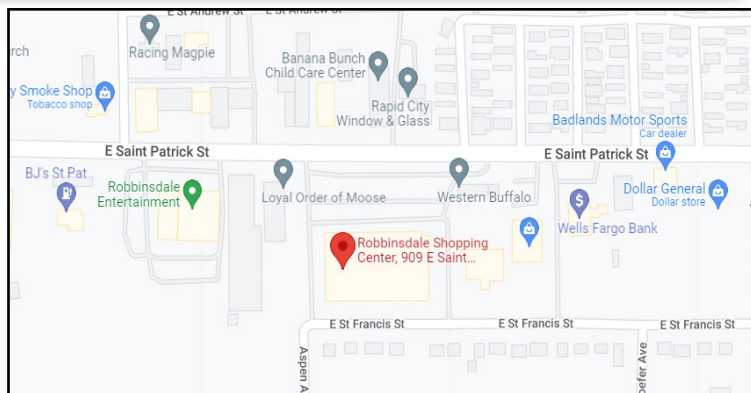

SPACES FOR LEASE

SUITE	SQFT	RATE
#1	12,176	\$8.00/SF/YR NNN
#7	4,895	\$10.00/SF/YR NNN



Disclaimer: The information contained herein has been given to us by the owner of the property or other sources we deem reliable. We have no reason to doubt its accuracy, but we do not guarantee it. All information should be verified prior to purchase or lease.

EXCLUSIVELY LISTED BY:

Gina Plooster
Leasing Agent
605.519.0749
gina@rapidcitycommercial.com

Jon Brue
Commercial Broker
605.939.1322
jonbrue@kwcommercial.com

OFFICE AND RETAIL SPACE

909 E ST PATRICK STREET
RAPID CITY, SD 57701

PHOTOS - SUITE 7



Disclaimer: The information contained herein has been given to us by the owner of the property or other sources we deem reliable. We have no reason to doubt its accuracy, but we do not guarantee it. All information should be verified prior to purchase or lease.

EXCLUSIVELY LISTED BY:

Gina Plooster

Leasing Agent

605.519.0749

gina@rapidcitycommercial.com

Jon Brue

Commercial Broker

605.939.1322

jonbrue@kwcommercial.com

OFFICE AND RETAIL SPACE

909 E ST PATRICK STREET
RAPID CITY, SD 57701

FLOOR PLAN - SUITE 7

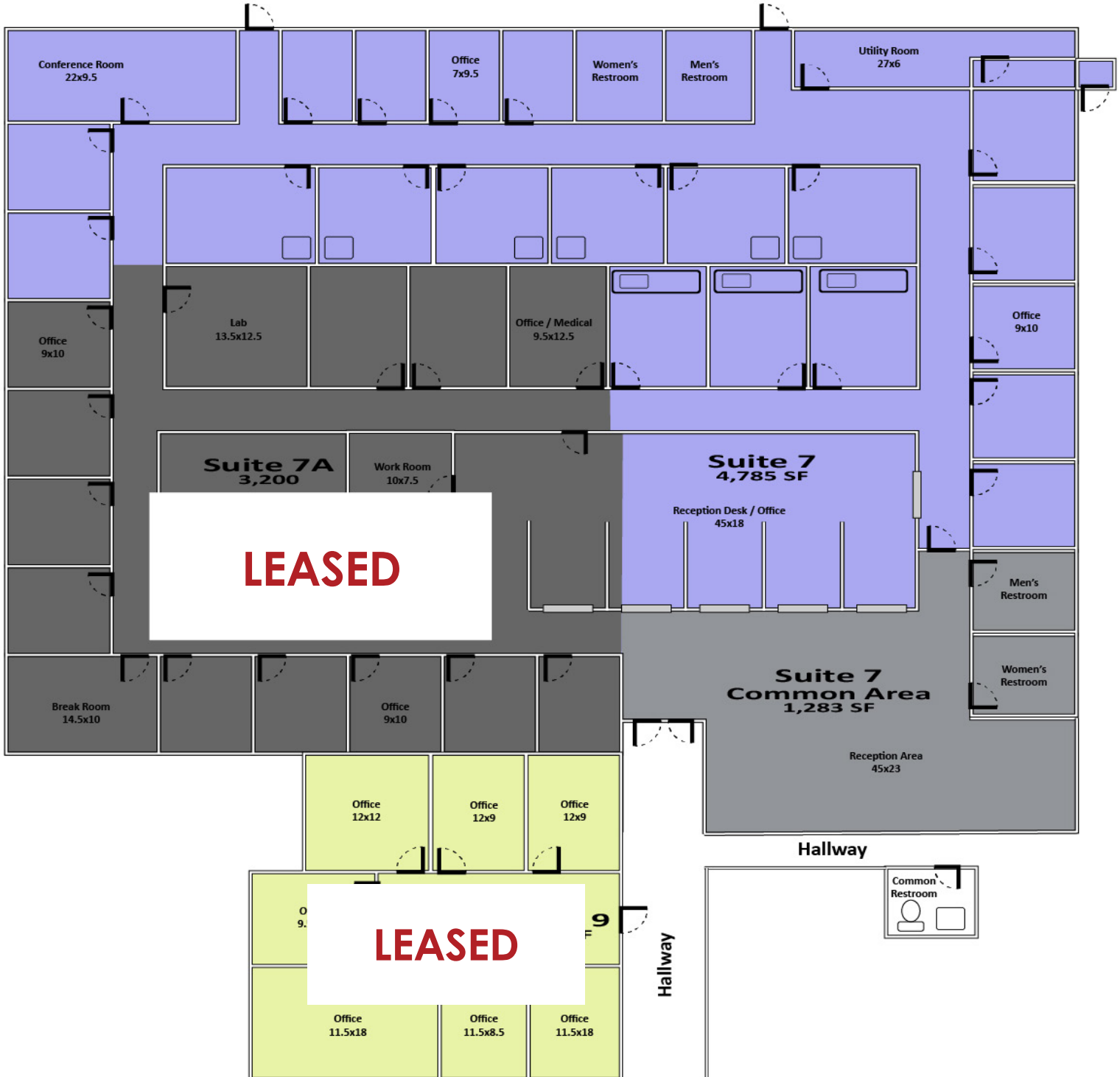

Disclaimer: The information contained herein has been given to us by the owner of the property or other sources we deem reliable. We have no reason to doubt its accuracy, but we do not guarantee it. All information should be verified prior to purchase or lease.

EXCLUSIVELY LISTED BY:

Gina Plooster

Leasing Agent

605.519.0749

gina@rapidcitycommercial.com

Jon Brue

Commercial Broker

605.939.1322

jonbrue@kwcommercial.com

